

# F30A Series Standard Damper Actuator



The damper actuator specially designed for the air dampers of the HVAC Systems

**Torque:**

2Nm、 5Nm、 10Nm、 20Nm、 30Nm、 40Nm

**Supply Voltage & Control:**

AC/DC19. 2-28. 8V or AC85-265V, 2/3 point

AC/DC19. 2-28. 8V, 0 (2)-10V or 0 (4)-20mA

**Order code:**

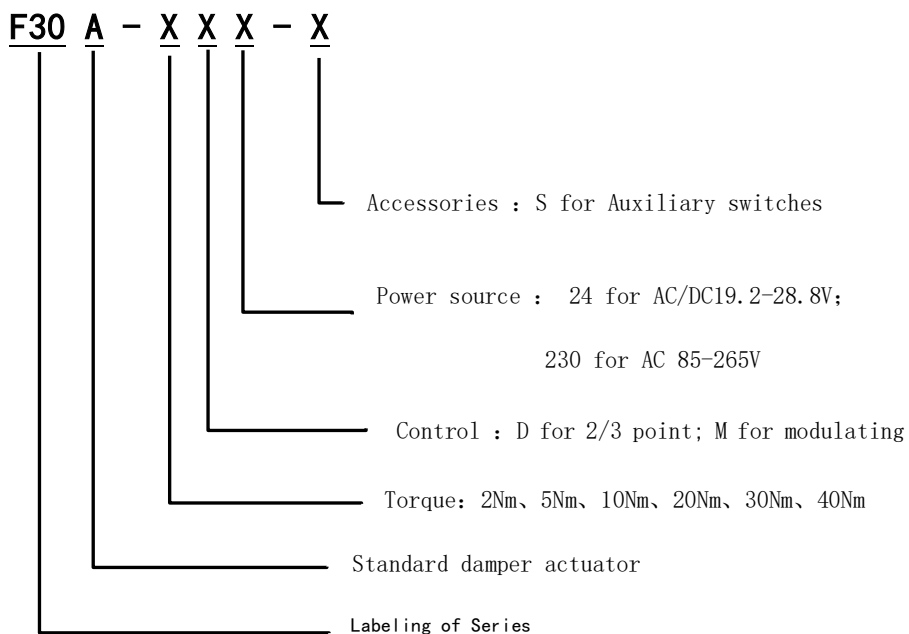

# F30A Series Standard Damper Actuator

## 2Nm Model Types



Model	Torque	Running Time	Nominal Voltage	Auxiliary Switches
F30A-2D24	2Nm	35s	AC/DC 24V Or AC 230V	Without
F30A-2D230				
F30A-2M24				
F30A-2D24-S				With 2 SPDT
F30A-2D230-S				
F30A-2M24-S				

## F30A-2 Specification

Items	F30A-2D24	F30A-2D230	F30A-2M24
		F30A-2D24-S	F30A-2D230-S

### Electrical parameters

Nominal Voltage (V)	AC/DC 24V 50/60Hz	AC 230V 50/60Hz	AC/DC 24V 50/60Hz
Nominal Voltage Range (V)	AC/DC 19.2-28.8V	AC 85-265V	AC/DC 19.2-28.8V
Power consumption (on)	1.5W		
Power consumption (off)	0.7W		
Cable	2/3 point: 1m cable 3*0.75mm <sup>2</sup> ; Modulating: 1m cable 4*0.5mm <sup>2</sup> ; Positional Feedback: 1m cable 6*0.5mm <sup>2</sup>		

### Technical parameters

Torque	2Nm		
Damper Area (m <sup>2</sup> )	0.5		
Running Time	35s		
Control Signal	2/3 point	0(2)-10V or 0(4)-20mA	
Angle of Rotation	0~90° (max 93°)		
Direction of Rotation	L/R switch		
Positional Feedback	None or 2 SPDT		
Life Cycle	≥70000		
Noise Level	≤ 45dB		

### Operating condition

Protection class	II/III		
Degree of Protection	IP54		
Ambient Temperature	-30~+50°C		
Ambient Humidity	5~95%RH		
Non-operating Temperature	-40~+80°C		

### Dimensions & weight

Spindle diameter		8-18mm
Weight (Kg)	0.5	
Certificates	CE, UKCA, UL, RoHS	

# F30A Series Standard Damper Actuator

## 5Nm Model Types



Model	Torque	Running Time	Nominal Voltage	Auxiliary Switches
F30A-5D24	5Nm	45s	AC/DC 24V Or AC 230V	Without
F30A-5D230				
F30A-5M24				
F30A-5D24-S				With 2 SPDT
F30A-5D230-S				
F30A-5M24-S				

## F30A-5 Specification

Items	F30A-5D24	F30A-5D230	F30A-5M24
		F30A-5D24-S	F30A-5D230-S

### Electrical parameters

Nominal Voltage (V)	AC/DC 24V 50/60Hz	AC 230V 50/60Hz	AC/DC 24V 50/60Hz
Nominal Voltage Range (V)	AC/DC 19.2-28.8V	AC 85-265V	AC/DC 19.2-28.8V
Power consumption (on)	1.5W		
Power consumption (off)	0.7W		
Cable	2/3 point: 1m cable 3*0.75mm <sup>2</sup> ; Modulating: 1m cable 4*0.5mm <sup>2</sup> ; Positional Feedback: 1m cable 6*0.5mm <sup>2</sup>		

### Technical parameters

Torque	5Nm		
Damper Area (m <sup>2</sup> )	1		
Running Time	45s		
Control Signal	2/3 point	0(2)-10V or 0(4)-20mA	
Angle of Rotation	0~90° (max 93°)		
Direction of Rotation	L/R switch		
Positional Feedback	None or 2 SPDT		
Life Cycle	≥70000		
Noise Level	≤ 45dB		

### Operating condition

Protection class	II/III		
Degree of Protection	IP54		
Ambient Temperature	-30~+50°C		
Ambient Humidity	5~95%RH		
Non-operating Temperature	-40~+80°C		

### Dimensions & weight

Spindle diameter		8-18mm
Weight (Kg)	0.5	
Certificates	CE, UKCA, UL, RoHS	

# F30A Series Standard Damper Actuator

## 10Nm Model Type



Model	Torque	Running Time	Nominal Voltage	Auxiliary Switches
F30A-10D24	10Nm	60s	AC/DC 24V Or AC 230V	Without
F30A-10D230				
F30A-10M24				
F30A-10D24-S				With 2 SPDT
F30A-10D230-S				
F30A-10M24-S				

## F30A-10 Specification

Items	F30A-10D24	F30A-10D230	F30A-10M24
		F30A-10D24-S	F30A-10D230-S

### Electrical parameters

Nominal Voltage (V)	AC/DC 24V 50/60Hz	AC 230V 50/60Hz	AC/DC 24V 50/60Hz
Nominal Voltage	AC/DC19.2-28.8V	AC 85-265V	AC/DC19.2-28.8V
Power consumption (on)	2.5W (24V) ; 3.5W (230V)		
Power consumption (off)	0.7W (24V) ; 1W (230V)		
Cable	2/3 point: 1m cable 3*0.75mm <sup>2</sup> ; Modulating: 1m cable 4*0.5mm <sup>2</sup> ; Positional Feedback: 1m cable 6*0.5mm <sup>2</sup>		

### Technical parameters

Torque	10Nm		
Damper Area (m <sup>2</sup> )	2		
Running Time	60s		
Control Signal	2/3 point	0(2)-10V or 0(4)-20mA	
Angle of Rotation	0~90° (max 93°)		
Direction of Rotation	L/R switch		
Positional Feedback	None or 2 SPDT		
Life Cycle	≥70000		
Noise Level	≤ 45dB		

### Operating condition

Protection class	II/III		
Degree of Protection	IP54		
Ambient Temperature	-30~+50°C		
Ambient Humidity	5~95%RH		
Non-operating Temperature	-40~+80°C		

### Dimensions & weight

Spindle diameters		12-26.7mm
Weight (Kg)	0.9	
Certificates	CE, UKCA, UL, RoHS	

# F30A Series Standard Damper Actuator

## 20Nm Model Type



Model	Torque	Running Time	Nominal Voltage	Auxiliary Switches
F30A-20D24	20Nm	75s	AC/DC 24V Or AC 230V	Without
F30A-20D230				
F30A-20M24				
F30A-20D24-S				With 2 SPDT
F30A-20D230-S				
F30A-20M24-S				

## F30A-20 Specification

Items	F30A-20D24	F30A-20D230	F30A-20M24
		F30A-20D24-S	F30A-20D230-S

### Electrical parameters

Nominal Voltage (V)	AC/DC 24V 50/60Hz	AC 230V 50/60Hz	AC/DC 24V 50/60Hz
Nominal Voltage	AC/DC19.2-28.8V	AC 85-265V	AC/DC19.2-28.8V
Power consumption (on)	2.5W (24V) ; 3.5W (230V)		
Power consumption (off)	0.7W (24V) ; 1W (230V)		
Cable	2/3 point: 1m cable 3*0.75mm <sup>2</sup> ; Modulating: 1m cable 4*0.5mm <sup>2</sup> ; Positional Feedback: 1m cable 6*0.5mm <sup>2</sup>		

### Technical parameters

Torque	20Nm		
Damper Area (m <sup>2</sup> )	4		
Running Time	75s		
Control Signal	2/3 point	0(2)-10V or 0(4)-20mA	
Angle of Rotation	0~90° (max 93°)		
Direction of Rotation	L/R switch		
Positional Feedback	None or 2 SPDT		
Life Cycle	≥70000		
Noise Level	≤ 45dB		

### Operating condition

Protection class	II/III		
Degree of Protection	IP54		
Ambient Temperature	-30~+50°C		
Ambient Humidity	5~95%RH		
Non-operating Temperature	-40~+80°C		

### Dimensions & weight

Spindle diameter		12-26.7mm
Weight (Kg)	0.9	
Certificates	CE, UKCA, UL, RoHS	

# F30A Series Standard Damper Actuator

## 30Nm Model Type



Model	Torque	Running Time	Nominal Voltage	Auxiliary Switches
F30A-30D24	30Nm	75s	AC/DC 24V Or AC 230V	Without
F30A-30D230				
F30A-30M24				
F30A-30D24-S				With 2 SPDT
F30A-30D230-S				
F30A-30M24-S				

## F30A-30 Specification

Items	F30A-30D24	F30A-30D230	F30A-30M24
	F30A-30D24-S	F30A-30D230-S	F30A-30M24-S

### Electrical parameters

Nominal Voltage (V)	AC/DC 24V 50/60Hz	AC 230V 50/60Hz	AC/DC 24V 50/60Hz
Nominal Voltage	AC/DC19.2-28.8V	AC 85-265V	AC/DC19.2-28.8V
Power consumption (on)	5W (24V) ; 5W (230V)		
Power consumption (off)	0.7W (24V) ; 1W (230V)		
Cable	2/3 point: 1m cable 3*0.75mm <sup>2</sup> ; Modulating: 1m cable 4*0.5mm <sup>2</sup> ; Positional Feedback: 1m cable 6*0.5mm <sup>2</sup>		

### Technical parameters

Torque	30Nm		
Damper Area (m <sup>2</sup> )	6		
Running Time	75s		
Control Signal	2/3 point	0(2)-10V or 0(4)-20mA	
Angle of Rotation	0~90° (max 93°)		
Direction of Rotation	L/R switch		
Positional Feedback	None or 2 SPDT		
Life Cycle	≥70000		
Noise Level	≤ 45dB		

### Operating condition

Protection class	II / III		
Degree of Protection	IP54		
Ambient Temperature	-30~+50°C		
Ambient Humidity	5~95%RH		
Non-operating Temperature	-40~+80°C		

### Dimensions & weight

Spindle diameter		12-26.7mm
Weight (Kg)	1.4	
Certificates	CE, UKCA, UL, RoHS	

# F30A Series Standard Damper Actuator

## 40Nm Model I Type



Model	Torque	Running Time	Nominal Voltage	Auxiliary Switches
F30A-40D24	40Nm	100s	AC/DC 24V Or AC 230V	Without
F30A-40D230				
F30A-40M24				
F30A-40D24-S				With 2 SPDT
F30A-40D230-S				
F30A-40M24-S				

## F30A-40 Specification

Items	F30A-40D24	F30A-40D230	F30A-40M24
	F30A-40D24-S	F30A-40D230-S	F30A-40M24-S

### Electrical parameters

Nominal Voltage (V)	AC/DC 24V 50/60Hz	AC 230V 50/60Hz	AC/DC 24V 50/60Hz
Nominal Voltage	AC/DC19. 2-28. 8V	AC 85-265V	AC/DC19. 2-28. 8V
Power consumption (on)	5W (24V)		
Power consumption (off)	0. 7W (24V)		
Cable	2/3 point: 1m cable 3*0. 75mm <sup>2</sup> ; Modulating: 1m cable 4*0. 5mm <sup>2</sup> ; Positional Feedback: 1m cable 6*0. 5mm <sup>2</sup>		

### Technical parameters

Torque	40Nm		
Damper Area (m <sup>2</sup> )	8		
Running Time	100s		
Control Signal	2/3 point		0(2)-10V or 0(4)-20mA
Angle of Rotation	0~90° (max 93°)		
Direction of Rotation	L/R switch		
Positional Feedback	None or 2 SPDT		
Life Cycle	≥70000		
Noise Level	≤ 45dB		

### Operating condition

Protection class	II /III		
Degree of Protection	IP54		
Ambient Temperature	-30~+50°C		
Ambient Humidity	5~95%RH		
Non-operating	-40~+80°C		

### Dimensions & weight

Spindle diameter		12-26. 7mm
Weight (Kg)	1. 4	
Certificates	CE, UKCA, UL, RoHS	

# F30A Series Standard Damper Actuator

## F30A-2/5 Spindle Dimension

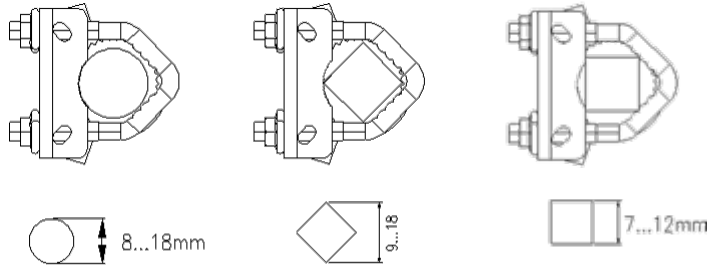

Unit: mm

shaft	Length			
	$\geq 40$	8.....18	$\geq 7$	$\leq 18$

## F30A-2/5 Unit Dimension (mm)

F30A-2/5D24  
F30A-2/5M24

F30A-2/5M24-S F30A-2/5D230-S  
F30A-2/5D24-S F30A-2/5D230

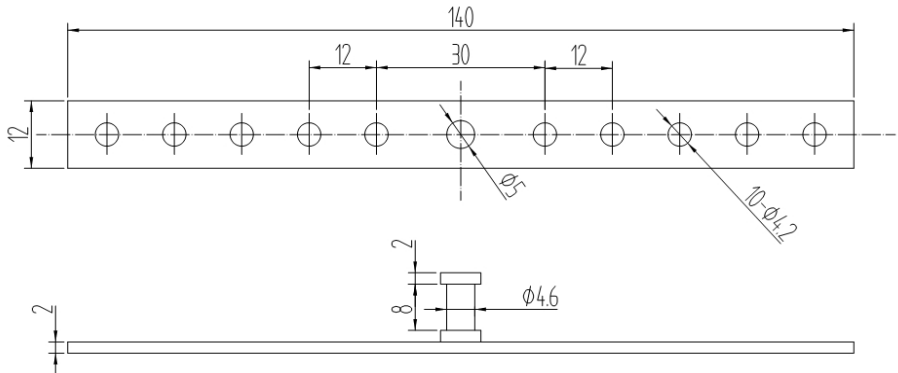
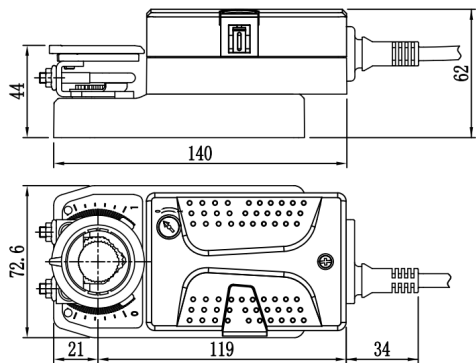
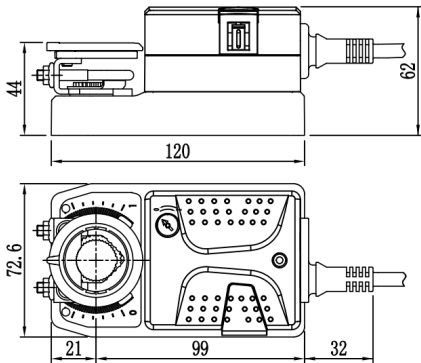

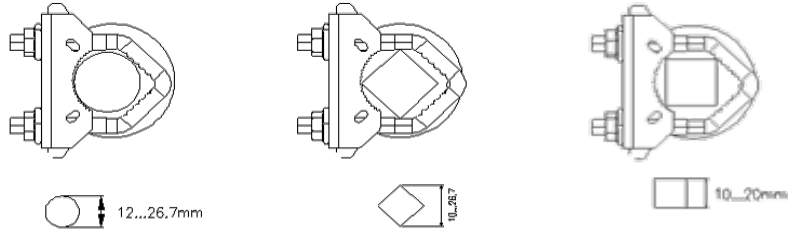

# F30A Series Standard Damper Actuator

## F30A-10/20 Spindle Dimension

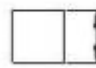

Unit: mm

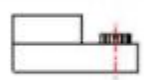
shaft	Length			
	≥40	8.....18	≥7	≤18

## F30A-10/20 Unit Dimension (mm)

F30A-10/20D24

F30A-10/20M24-S

F30A-10/20D230-S

F30A-10/20M24

F30A-10/20D24-S

F30A-10/20D230

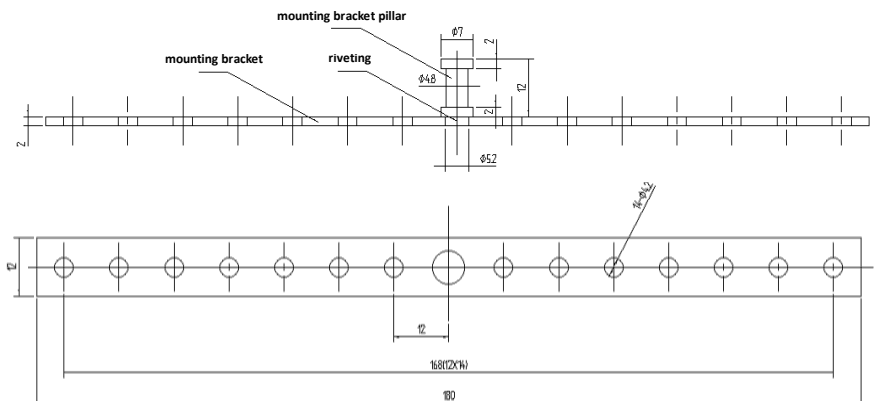
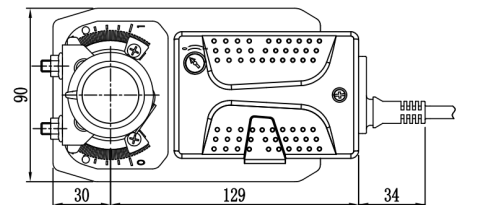
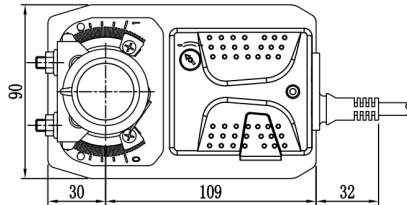
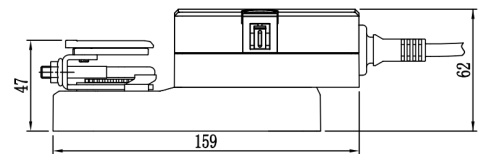
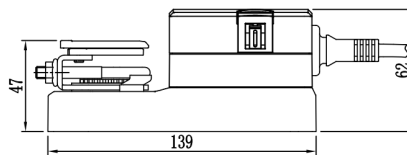

# F30A Series Standard Damper Actuator

## F30A-30/40 Spindle Dimension

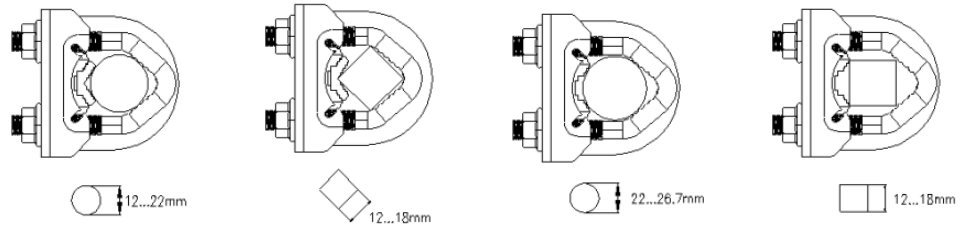

Unit: mm

shaft	Length			
	$\geq 52$	$22 \dots 26.7$	$\geq 12$	$\leq 26.7$

## F30A-30/40 Unit Dimension (mm)

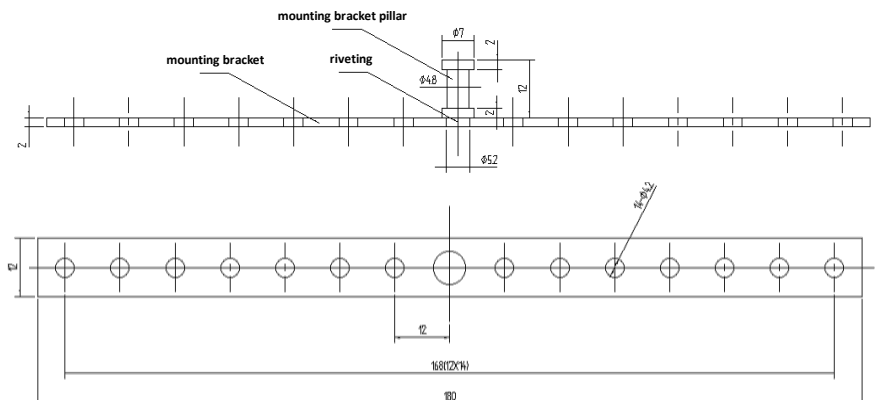
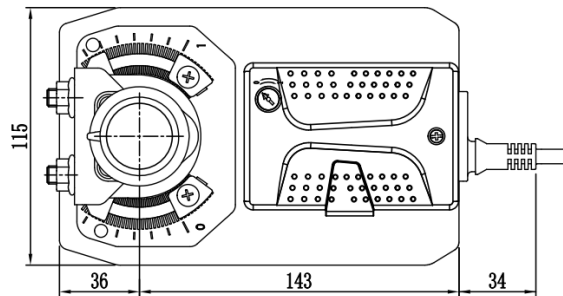
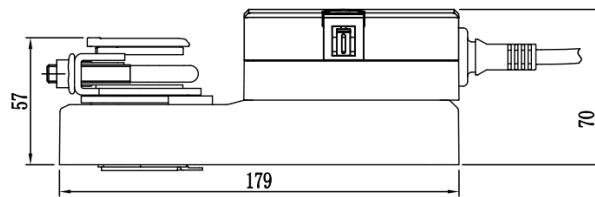

# F30A series Low Noise Damper Actuator



The damper actuator specially designed for the air dampers of the HVAC Systems

### Torque:

2Nm、 5Nm、 10Nm

### Supply Voltage & Control:

AC/DC19. 2-28. 8V or AC85-265V, 2/3 point

AC/DC19. 2-28. 8V, 0 (2) -10V or 0 (4) -20mA

### Order code:

F30 A - X X X - X

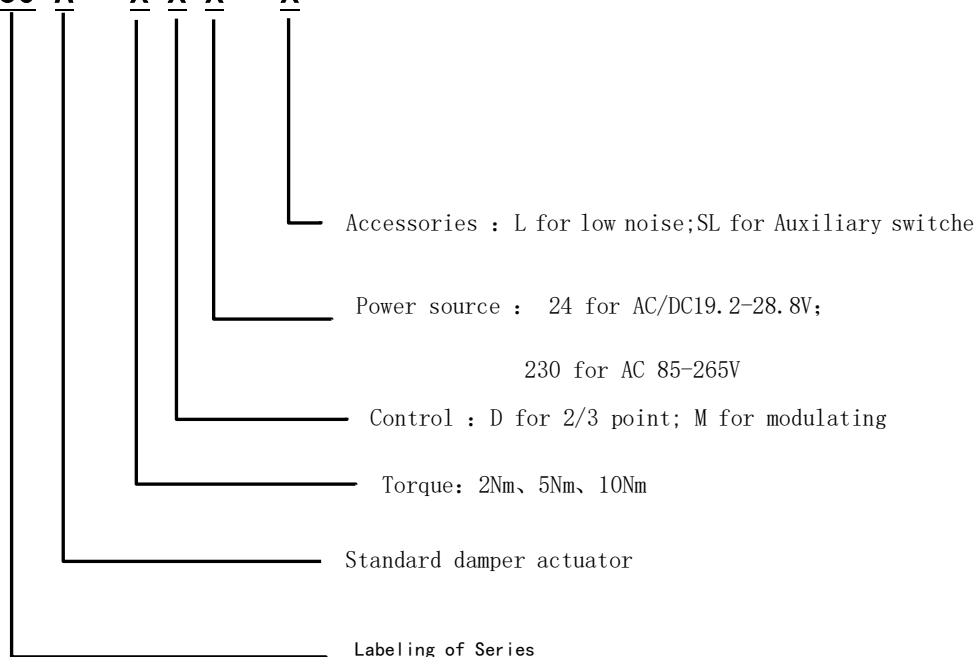

# F30A series Low Noise Damper Actuator

## 2Nm Model Type



Model	Torque	Running Time	Nominal Voltage	Auxiliary Switches
F30A-2D24-L	2Nm	75s	AC/DC 24V Or AC 230V	Without
F30A-2D230-L				
F30A-2M24-L				
F30A-2D24-SL				With 2 SPDT
F30A-2D230-SL				
F30A-2M24-SL				

## F30A-2-L Specification

Items	F30A-2D24-L	F30A-2D230-L	F30A-2M24-L
		F30A-2D24-SL	F30A-2D230-SL

### Electrical parameters

Nominal Voltage (V)	AC/DC 24V 50/60Hz	AC 230V 50/60Hz	AC/DC 24V 50/60Hz
Nominal Voltage Range	AC/DC19. 2-28. 8V	AC 85-265V	AC/DC19. 2-28. 8V
Power consumption (on)	1. 5W		
Power consumption (off)	0. 7W		
Cable	2/3 point: 1m cable 3*0. 75mm <sup>2</sup> ; Modulating: 1m cable 4*0. 5mm <sup>2</sup> ; Positional Feedback: 1m cable 6*0. 5mm <sup>2</sup>		

### Technical parameters

Torque	2Nm		
Damper Area (m <sup>2</sup> )	0. 5		
Running Time	75s		
Control Signal	2/3 point		0(2)-10V or 0(4)-20mA
Angle of Rotation	0~90° (max 93°)		
Direction of Rotation	L/R switch		
Positional Feedback	None or 2 SPDT		
Life Cycle	≥70000		
Noise Level	≤ 35dB		

### Operating condition

Protection	II /III		
Degree of Protection	IP54		
Ambient Temperature	-30~+50°C		
Ambient Humidity	5~95%RH		
Non-operating Temperature	-40~+80°C		

### Dimensions & weight

Spindle diameter		8-18mm
Weight (Kg)	0. 5	
Certificates	CE, UKCA, RoHS	

# F30A series Low Noise Damper Actuator

## 5Nm Model Type



Model	Torque	Running Time	Nominal Voltage	Auxiliary Switches
F30A-5D24-L	5Nm	150s	AC/DC 24V Or AC 230V	Without
F30A-5D230-L				
F30A-5M24-L				
F30A-5D24-SL				With 2 SPDT
F30A-5D230-SL				
F30A-5M24-SL				

## F30A-5-L Specification

Items	F30A-5D24-L	F30A-5D230-L	F30A-5M24-L
		F30A-5D24-SL	F30A-5D230-SL

### Electrical parameters

Nominal Voltage (V)	AC/DC 24V 50/60Hz	AC 230V 50/60Hz	AC/DC 24V 50/60Hz
Nominal Voltage	AC/DC19.2-28.8V	AC 85-265V	AC/DC19.2-28.8V
Power consumption (on)	1.5W		
Power consumption (off)	0.7W		
Cable	2/3 point: 1m cable 3*0.75mm <sup>2</sup> ; Modulating: 1m cable 4*0.5mm <sup>2</sup> ; Positional Feedback: 1m cable 6*0.5mm <sup>2</sup>		

### Technical parameters

Torque	5Nm		
Damper Area (m <sup>2</sup> )	1		
Running Time	150s		
Control Signal	2/3 point	0(2)-10V or 0(4)-20mA	
Angle of Rotation	0~90° (max 93°)		
Direction of Rotation	L/R switch		
Positional Feedback	None or 2 SPDT		
Life Cycle	≥70000		
Noise Level	≤ 35dB		

### Operating condition

Protection class	II/III		
Degree of Protection	IP54		
Ambient Temperature	-30~+50°C		
Ambient Humidity	5~95%RH		
Non-operating Temperature	-40~+80°C		

### Dimensions & weight

Spindle diameter		8-18mm
Weight (Kg)	0.5	
Certificates	CE, UKCA, RoHS	

# F30A series Low Noise Damper Actuator

## 10Nm Model Type



Model	Torque	Running Time	Nominal Voltage	Auxiliary Switches
F30A-10D24-L	10Nm	150s	AC/DC 24V Or AC 230V	Without
F30A-10D230-L				
F30A-10M24-L				
F30A-10D24-SL				With 2 SPDT
F30A-10D230-SL				
F30A-10M24-SL				

## F30A-10-L Specification

Items	F30A-10D24-L	F30A-10D230-L	F30A-10M24-L
		F30A-10D24-SL	F30A-10D230-SL

### Electrical parameters

Nominal Voltage (V)	AC/DC 24V 50/60Hz	AC 230V 50/60Hz	AC/DC 24V 50/60Hz
Nominal Voltage	AC/DC19.2-28.8V	AC 85-265V	AC/DC19.2-28.8V
Power consumption (on)	2.5W (24V) ; 3.5W (230V)		2.5W
Power consumption (off)	0.7W (24V) ; 1W (230V)		0.7W
Cable	2/3 point: 1m cable 3*0.75mm <sup>2</sup> ; Modulating: 1m cable 4*0.5mm <sup>2</sup> ; Positional Feedback: 1m cable 6*0.5mm <sup>2</sup>		

### Technical parameters

Torque	10Nm		
Damper Area (m <sup>2</sup> )	2		
Running Time	150s		
Control Signal	2/3 point	0(2)-10V or 0(4)-20mA	
Angle of Rotation	0~90° (max 93°)		
Direction of Rotation	L/R switch		
Positional Feedback	None or 2 SPDT		
Life Cycle	≥70000		
Noise Level	≤ 35dB		

### Operating condition

Protection class	II/III		
Degree of Protection	IP54		
Ambient Temperature	-30~+50°C		
Ambient Humidity	5~95%RH		
Non-operating Temperature	-40~+80°C		

### Dimensions & weight

Spindle diameter		12-26.7mm
Weight (Kg)	0.9	
Certificates	CE, UKCA, RoHS	

# F30A series Low Noise Damper Actuator

## F30A-2/5 Spindle Dimension

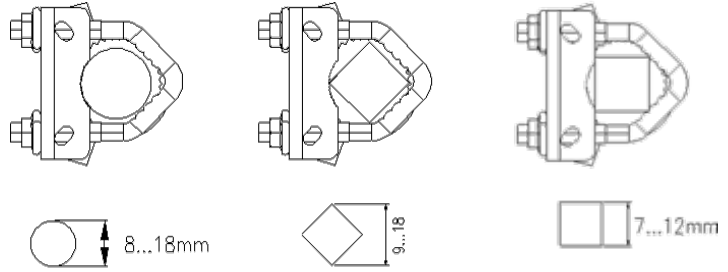

Unit: mm

shaft	Length			
	≥40	8.....18	≥7	≤18

## F30A-2/5 Unit Dimension (mm)

F30-A2/5D24-L

F30-A2/5M24-L

F30A-2/5M24-SL

F30A-2/5D230-SL

F30A-2/5D24-SL

F30A-2/5D230-L

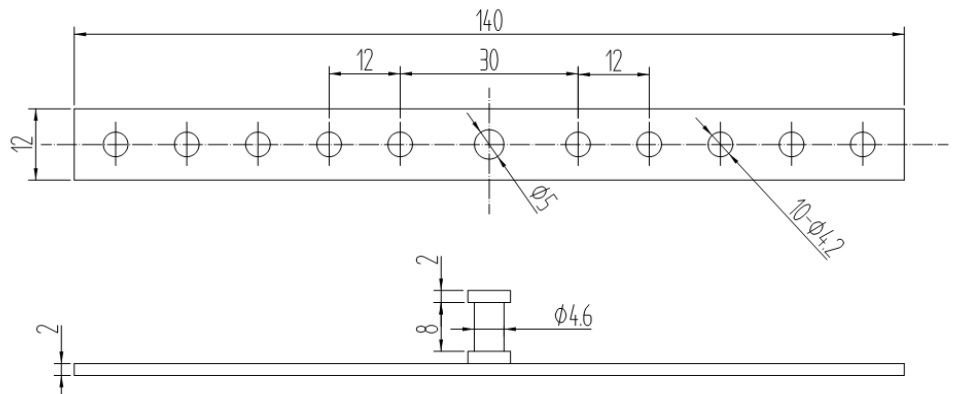
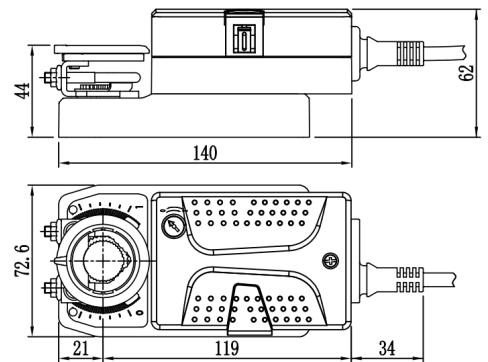
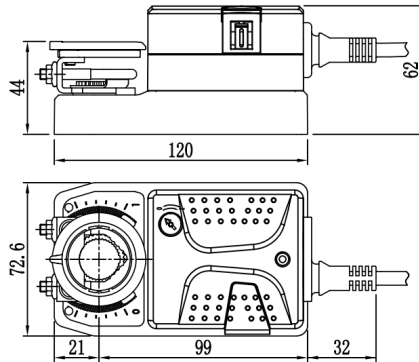

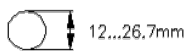
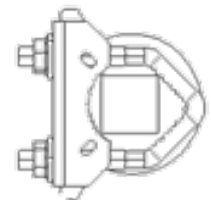
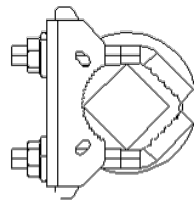
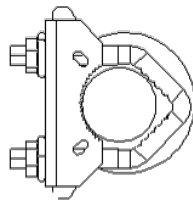

# F30A series Low Noise Damper Actuator

## F30A-10 Spindle Dimension

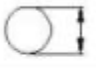
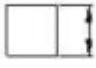

Unit: mm

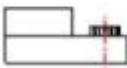
shaft	Length			
	$\geq 42$	12.....26.7	$\geq 10$	$\leq 26.7$

## F30A-10 Unit Dimension (mm)

F30A-10D24-L

F30A-10M24-L

F30A-10M24-SL

F30A-10D230-SL

F30A-10D24-SL

F30A-10D230-L

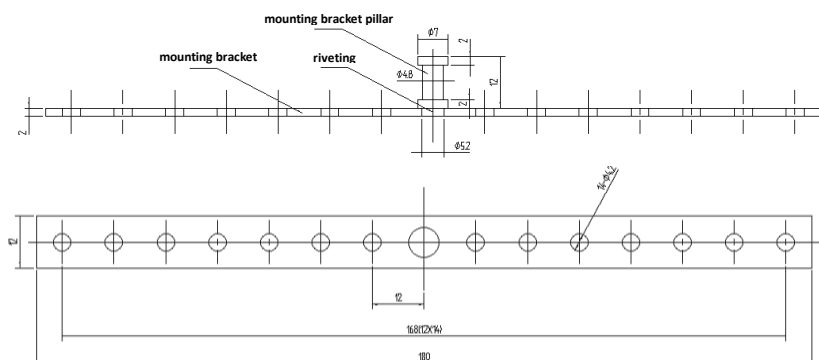
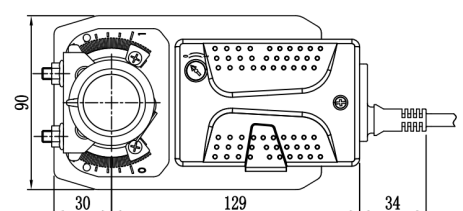
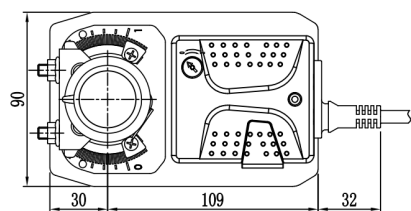
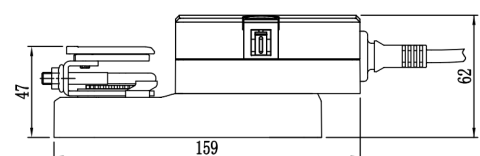
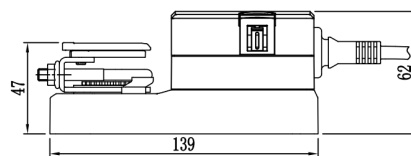

# F30A series Fast Running Damper Actuator



The damper actuator specially designed for the air dampers of the HVAC Systems

### Torque:

5Nm, 10Nm, 16Nm

### Supply Voltage & Control:

AC/DC19.2-28.8V or AC85-265V, 2/3 point

AC/DC19.2-28.8V, 0(2)-10V or 0(4)-20mA

### Order code:

**F30 A - X X X - X**

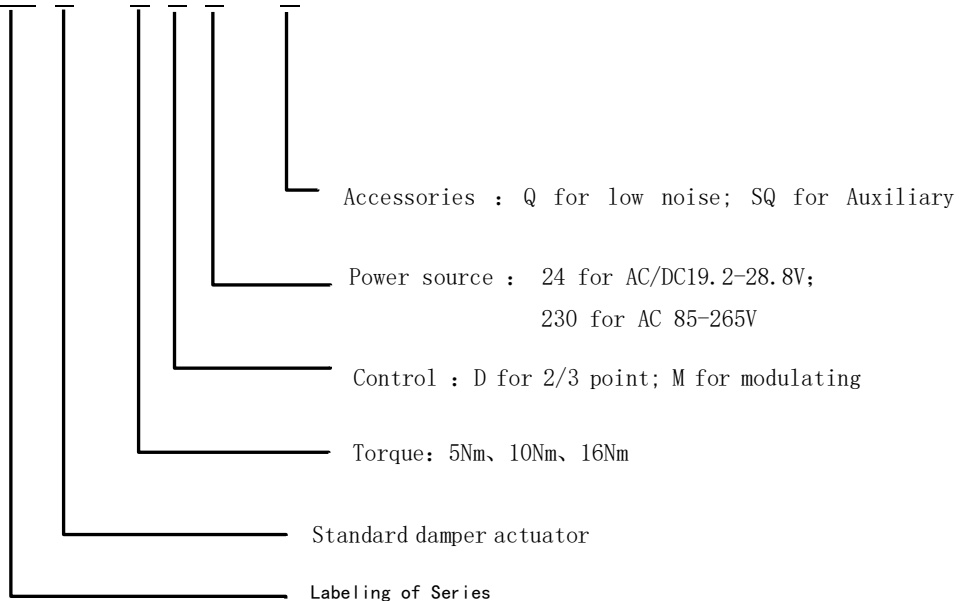

# F30A series Fast Running Damper Actuator

## 5Nm Model Type



Model	Torque	Running Time	Nominal Voltage	Auxiliary Switches
F30A-5D24-Q	5Nm	2.5s-3.5s	AC/DC 24V Or AC 230V	Without
F30A-5D230-Q				
F30A-5M24-Q				
F30A-5D24-SQ				With 2 SPDT
F30A-5D230-SQ				
F30A-5M24-SQ				

## F30A-5-Q Specification

Items	F30A-5D24-Q	F30A-5D230-Q	F30A-5M24-Q
	F30A-5D24-SQ	F30A-5D230-SQ	F30A-5M24-SQ
<b>Electrical parameters</b>			
Nominal Voltage (V)	AC/DC 24V 50/60Hz	AC 230V 50/60Hz	AC/DC 24V 50/60Hz
Nominal Voltage	AC/DC19.2-28.8V	AC 85-265V	AC/DC19.2-28.8V
Power consumption (on)	15W		
Power consumption (off)	2W		
Cable	2/3 point: 1m cable 3*0.75mm <sup>2</sup> ; Modulating: 1m cable 4*0.5mm <sup>2</sup> ; Positional Feedback: 1m cable 6*0.5mm <sup>2</sup>		
<b>Technical parameters</b>			
Torque	5Nm		
Damper Area (m <sup>2</sup> )	1		
Running Time	2.5s-3.5s		
Control Signal	2/3 point		0(2)-10V or 0(4)-20mA
Angle of Rotation	0~90° (max 93°)		
Direction of Rotation	L/R switch		
Positional Feedback	None or 2 SPDT		
Life Cycle	≥ 30000		
Noise Level	60dB		
<b>Operating condition</b>			
Protection class	II/III		
Degree of Protection	IP54		
Ambient Temperature	-30~+50°C		
Ambient Humidity	5~95%RH		
Non-operating Temperature	-40~+80°C		
<b>Dimensions &amp; weight</b>			
Spindle diameter		12-26.7mm	
Weight (Kg)	1.0		
Certificates	CE, UKCA, RoHS		

# F30A series Fast Running Damper Actuator

## 10Nm Model Type



Model	Torque	Running Time	Nominal Voltage	Auxiliary Switches
F30A-10D24-Q	10Nm	4s-5s	AC/DC 24V Or AC 230V	Without
F30A-10D230-Q				
F30A-10M24-Q				
F30A-10D24-SQ				With 2 SPDT
F30A-10D230-SQ				
F30A-10M24-SQ				

## F30A-10-Q Specification

Items	F30A-10D24-Q	F30A-10D230-Q	F30A-10M24-Q
	F30A-10D24-SQ	F30A-10D230-SQ	F30A-10M24-SQ

### Electrical parameters

Nominal Voltage (V)	AC/DC 24V 50/60Hz	AC 230V 50/60Hz	AC/DC 24V 50/60Hz
Nominal Voltage	AC/DC19.2-28.8V	AC 85-265V	AC/DC19.2-28.8V
Power consumption (on)	15W		
Power consumption (off)	2W		
Cable	2/3 point: 1m cable 3*0.75mm <sup>2</sup> ; Modulating: 1m cable 4*0.5mm <sup>2</sup> ; Positional Feedback: 1m cable 6*0.5mm <sup>2</sup>		

### Technical parameters

Torque	10Nm		
Damper Area (m <sup>2</sup> )	2		
Running Time	4s-5s		
Control Signal	2/3 point	0(2)-10V or 0(4)-20mA	
Angle of Rotation	0~90° (max 93°)		
Direction of Rotation	L/R switch		
Positional Feedback	None or 2 SPDT		
Life Cycle	≥30000		
Noise Level	55dB		

### Operating condition

Protection class	II/III		
Degree of Protection	IP54		
Ambient Temperature	-30~+50°C		
Ambient Humidity	5~95%RH		
Non-operating Temperature	-40~+80°C		

### Dimensions & weight

Spindle diameter		12-26.7mm
Weight (Kg)	1.0	
Certificates	CE, UKCA, RoHS	

# F30A series Fast Running Damper Actuator

## 16Nm Model Type



Model	Torque	Running Time	Nominal Voltage	Auxiliary Switches
F30A-16D24-Q	16Nm	7s-8s	AC/DC 24V Or AC 230V	Without
F30A-16D230-Q				
F30A-16M24-Q				
F30A-16D24-SQ				With 2 SPDT
F30A-16D230-SQ				
F30A-16M24-SQ				

## F30A-16-Q Specification

Items	F30A-16D24-Q	F30A-16D230-Q	F30A-16M24-Q
		F30A-16D24-SQ	F30A-16D230-SQ

### Electrical parameters

Nominal Voltage (V)	AC/DC 24V 50/60Hz	AC 230V 50/60Hz	AC/DC 24V 50/60Hz
Nominal Voltage	AC/DC19.2-28.8V	AC 85-265V	AC/DC19.2-28.8V
Power consumption (on)	15W		
Power consumption (off)	2W		
Cable	2/3 point: 1m cable 3*0.75mm <sup>2</sup> ; Modulating: 1m cable 4*0.5mm <sup>2</sup> ; Positional Feedback: 1m cable 6*0.5mm <sup>2</sup>		

### Technical parameters

Torque	16Nm		
Damper Area (m <sup>2</sup> )	4		
Running Time	7s-8s		
Control Signal	2/3 point		0(2)-10V or 0(4)-20mA
Angle of Rotation	0~90° (max 93°)		
Direction of Rotation	L/R switch		
Positional Feedback	None or 2 SPDT		
Life Cycle	≥30000		
Noise Level	55dB		

### Operating condition

Protection	II/III		
Degree of Protection	IP54		
Ambient Temperature	-30~+50°C		
Ambient Humidity	5~95%RH		
Non-operating	-40~+80°C		

### Dimensions & weight



Spindle diameter		12-26.7mm
Weight (Kg)	1.0	
Certificates	CE, UKCA, RoHS	

# F30A series Fast Running Damper Actuator

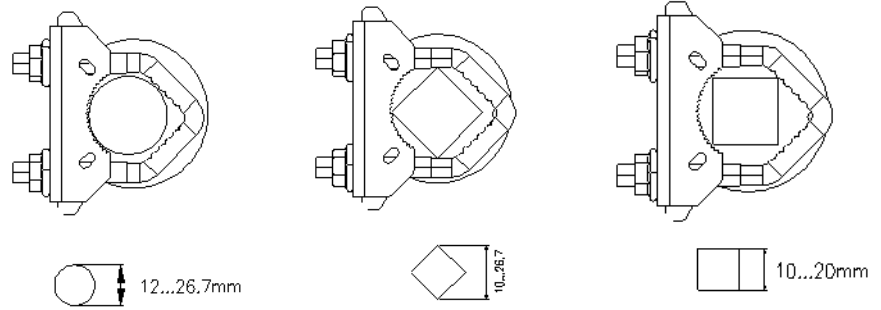
## F30A 5/10/16 Spindle Dimension

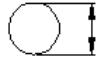

unit: mm

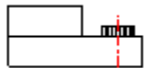
Spindle dimension	length			
	$\geq 42$	12.....26.7	$\geq 10$	$\leq 26.7$

## F30A5/10/16 Unit Dimension (mm)

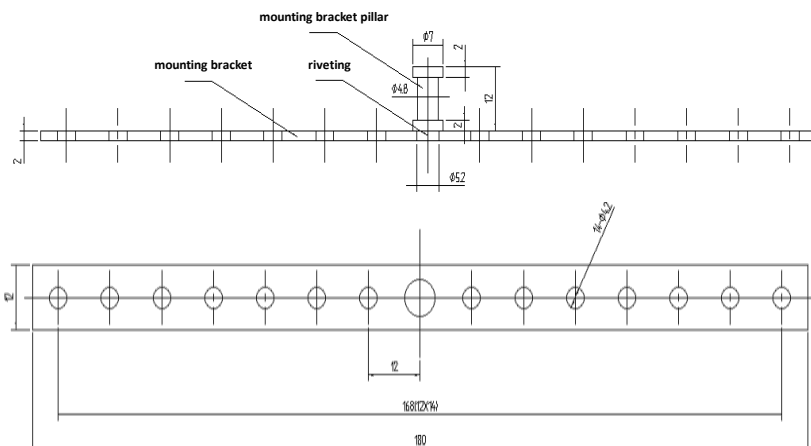
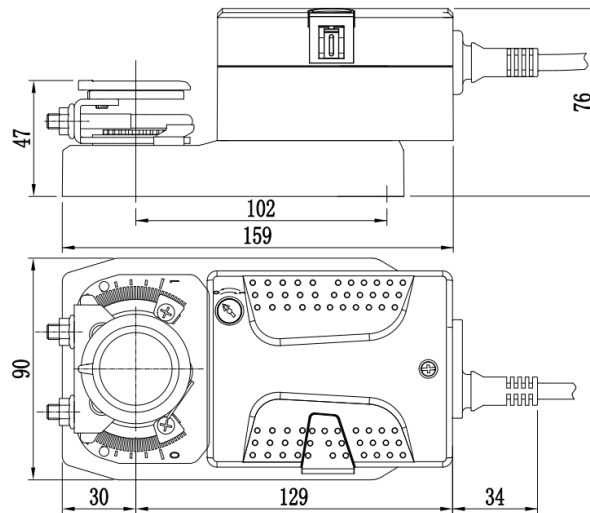

# F30A Electrical Installation & Other Specification

## Electrical Installation



On/off;floating

Modulating

2-point

3-point



- + AC/DC 19.2-28.8V  
 ~ AC 85-265V  
 N L1

- + AC/DC 19.2-28.8V  
 ~ AC 85-265V  
 N L1

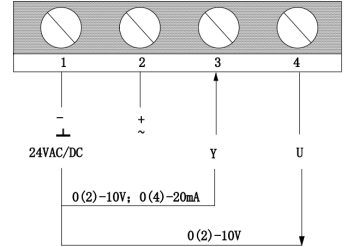

## Input Signal and Impedance

According to on-site needs, the status of the SW1 dial switch in the circuit board can be adjusted to achieve the conversion between control signals and feedback signals, as shown in the following figure.

## Direction of Rotation

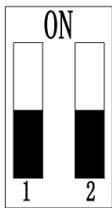

Input Signal : DC 0...10V  
 Feedback: DC 0...10V  
 Input resistance: Ri 150K Ω

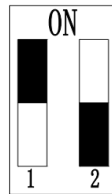

Input Signal: DC 0...20mA  
 Feedback: DC 0...10V  
 Input resistance: Ri 500 Ω

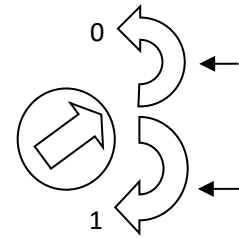

The arrow points to the icon, actuator 1 and 2 are powered to the "0" position.

The arrow points to the icon, actuator 1 and 2 are powered to the "1" position.

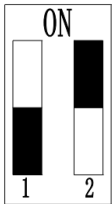

Input Signal : DC 2...10V  
 Feedback: DC 2...10V  
 Input resistance: Ri 150K Ω

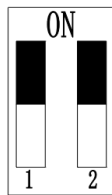

Input Signal: DC 4...20mA  
 Feedback: DC 2...10V  
 Input resistance: Ri 500 Ω

## Specification for Auxiliary Switch

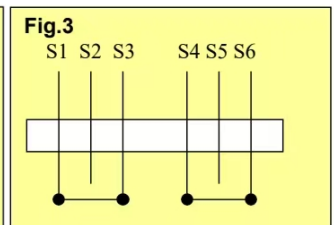
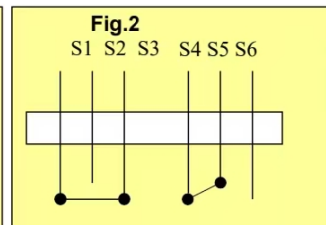
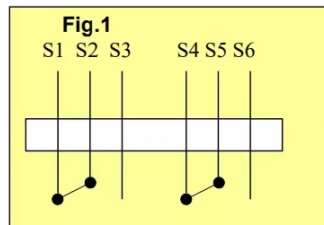
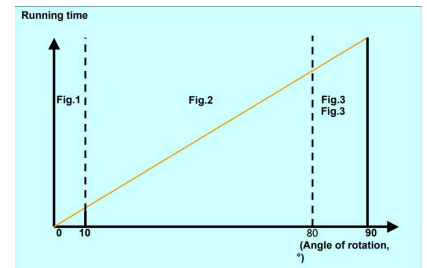
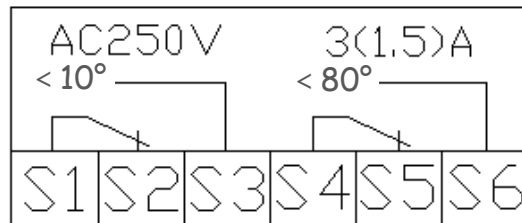

# F30S series Spring Return Damper Actuator



The damper actuator specially designed for the air dampers of the HVAC Systems

## Torque:

3.5Nm、5Nm、10Nm、15Nm、20Nm

## Supply Voltage & Control:

AC/DC 19.2–28.8V or AC 85–265V, 2/3 point

AC/DC 19.2–28.8V, 0(2)–10V or 0(4)–20mA

## Order code:

**F30 S - X X X - X**

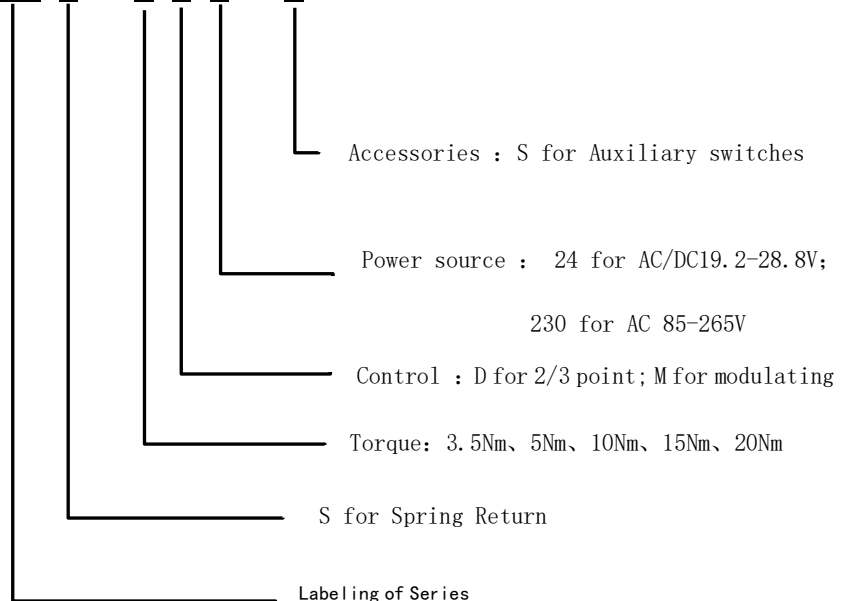

# F30S series Spring Return Damper Actuator

## 3.5Nm Model Type

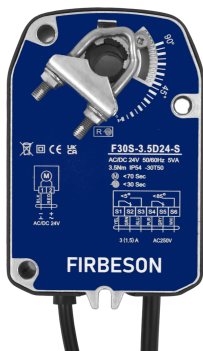

Model	Torque	Running Time	Nominal Voltage	Auxiliary Switches
F30S-3.5D24	3.5Nm	Motor Running <70s; Spring Return<30s	AC/DC 24V Or AC 230V	Without
F30S-3.5D230				
F30S-3.5M24				
F30S-3.5D24-S				With 2 SPDT
F30S-3.5D230-S				
F30S-3.5M24-S				

## F30S-3.5 Specification

Items	F30S-3.5D24	F30S-3.5D230	F30S-3.5M24
		F30S-3.5D24-S	F30S-3.5D230-S

### Electrical parameters

Nominal Voltage (V)	AC/DC 24V 50/60Hz	AC 230V 50/60Hz	AC/DC 24V 50/60Hz
Nominal Voltage	AC/DC19.2-28.8V	AC 85-265V	AC/DC19.2-28.8V
Power consumption (on)	2.5W		
Power consumption (off)	1.6W		
Cable	2/3 point: 1m cable 3*0.75mm <sup>2</sup> ; Modulating: 1m cable 4*0.5mm <sup>2</sup> ; Positional Feedback: 1m cable 6*0.5mm <sup>2</sup>		

### Technical parameters

Torque	3.5Nm		
Damper Area (m <sup>2</sup> )	0.8		
Running Time	Motor Running<70s; Spring Return<30s		
Control Signal	2 point		0(2)-10V
Angle of Rotation	0~90° (max 93°)		
Direction of Rotation	L/R switch		
Positional Feedback	None or 2 SPDT		
Life Cycle	≥70000		
Noise Level	50dB and 62dB		

### Operating condition

Protection class	II/III		
Degree of Protection	IP54		
Ambient Temperature	-30~+55°C		
Ambient Humidity	5~95%RH		
Non-operating Temperature	-40~+80°C		

### Dimensions & weight

Spindle diameter		8-14mm
Weights (Kg)	1.0	
Certificates	CE, UKCA, UL, RoHS	

# F30S series Spring Return Damper Actuator

## 5Nm Model Type

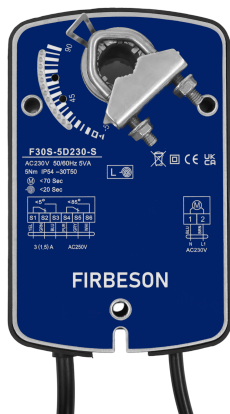

Model	Torque	Running Time	Nominal Voltage	Auxiliary Switches
F30S-5D24	5Nm	Motor Running<70s; Spring Return<20s (For Modulating Motor Running<120s; Spring Return<20s)	AC/DC 24V Or AC 230V	Without
F30S-5D230				
F30S-5M24				
F30S-5D24-S				With 2 SPDT
F30S-5D230-S				
F30S-5M24-S				

## F30S-5 Specification

Items	F30S-5D24	F30S-5D230	F30S-5M24
	F30S-5D24-S	F30S-5D230-S	F30S-5M24-S

### Electrical parameters

Nominal Voltage (V)	AC/DC 24V 50/60Hz	AC 230V 50/60Hz	AC/DC 24V 50/60Hz
Nominal Voltage	AC/DC19.2-28.8V	AC 85-265V	AC/DC19.2-28.8V
Power consumption (on)	5W		
Power consumption (off)	2.5W		
Cable	2/3 point: 1m cable 3*0.75mm <sup>2</sup> ; Modulating: 1m cable 4*0.5mm <sup>2</sup> ; Positional Feedback: 1m cable 6*0.5mm <sup>2</sup>		

### Technical parameters

Torque	5Nm		
Damper Area (m <sup>2</sup> )	1		
Running Time	Motor Running<70s; Spring Return<20s	Motor<120s; Spring<20s	
Control Signal	2 point		0(2)-10V
Angle of Rotation	0~90° (max 93°)		
Direction of Rotation	L/R switch		
Positional Feedback	None or 2 SPDT		None or 1 SPDT
Life Cycle	≥70000		
Noise Level	50dB and 62dB		

### Operating condition

Protection class	II /III		
Degree of Protection	IP54		
Ambient Temperature	-30~+55℃		
Ambient Humidity	5~95%RH		
Non-operating Temperature	-40~+80℃		

### Dimensions & weight

Spindle diameter		10-16mm;
Weight (Kg)	1.4	
Certificates	CE, UKCA, UL, RoHS	

# F30S series Spring Return Damper Actuator

## 10Nm Model Type



Model	Torque	Running Time	Nominal Voltage	Auxiliary Switches
F30S-10D24	10Nm	Motor Running<70s; Spring Return<30s (For Modulating Motor Running<120s; Spring Return<30s)	AC/DC 24V Or AC 230V	Without
F30S-10D230				
F30S-10M24				
F30S-10D24-S				With 2 SPDT
F30S-10D230-S				
F30S-10M24-S				

## F30S-10 Specification

Items	F30S-10D24	F30S-10D230	F30S-10M24
		F30S-10D24-S	F30S-10D230-S

### Electrical parameters

Nominal Voltage (V)	AC/DC 24V 50/60Hz	AC 230V 50/60Hz	AC/DC 24V 50/60Hz
Nominal Voltage	AC/DC19. 2-28. 8V	AC 85-265V	AC/DC19. 2-28. 8V
Power consumption (on)	5W		
Power consumption (off)	2. 5W		
Cable	2/3 point: 1m cable 3*0. 75mm <sup>2</sup> ; Modulating: 1m cable 4*0. 5mm <sup>2</sup> ; Positional Feedback: 1m cable 6*0. 5mm <sup>2</sup>		

### Technical parameters

Torque	10Nm		
Damper Area (m <sup>2</sup> )	2		
Running Time	Motor Running<100s; Spring Return<30s	Motor<120s; Spring<30s	
Control Signal	2 point		0(2)-10V
Angle of Rotation	0~90° (max 93°)		
Direction of Rotation	L/R switch		
Positional Feedback	None or 2 SPDT		
Life Cycle	≥70000		
Noise Level	50dB and 62dB		

### Operating condition

Protection	II /III		
Degree of Protection	IP54		
Ambient Temperature	-30~+55℃		
Ambient Humidity	5~95%RH		
Non-operating Temperature	-40~+80℃		

### Dimensions & weight

Spindle diameter		10-20mm;
Weight (Kg)	2. 4	
Certificates	CE, UKCA, UL, RoHS	

# F30S series Spring Return Damper Actuator

## 15Nm Model Type



Model	Torque	Running Time	Nominal Voltage	Auxiliary Switches
F30S-15D24	15Nm	Motor Running <130s; Spring Return<30s	AC/DC 24V Or AC 230V	Without
F30S-15D230				
F30S-15M24				
F30S-15D24-S				With 2 SPDT
F30S-15D230-S				
F30S-15M24-S				

## F30S-15 Specification

Items	F30S-15D24	F30S-15D230	F30S-15M24
	F30S-15D24-S	F30S-15D230-S	F30S-15M24-S
<b>Electrical parameters</b>			
Nominal Voltage (V)	AC/DC 24V 50/60Hz	AC 230V 50/60Hz	AC/DC 24V 50/60Hz
Nominal Voltage	AC/DC19.2-28.8V	AC 85-265V	AC/DC19.2-28.8V
Power consumption (on)	6W		
Power consumption (off)	2.5W		
Cable	2/3 point: 1m cable 3*0.75mm <sup>2</sup> ; Modulating: 1m cable 4*0.5mm <sup>2</sup> ; Positional Feedback: 1m cable 6*0.5mm <sup>2</sup>		
<b>Technical parameters</b>			
Torque	15Nm		
Damper Area (m <sup>2</sup> )	3		
Running Time	Motor Running<130s; Spring Return<30s		
Control Signal	2 point		0(2)-10V
Angle of Rotation	0~90° (max 93°)		
Direction of Rotation	L/R switch		
Positional Feedback	None or 2 SPDT		
Life Cycle	≥70000		
Noise Level	50dB and 62dB		
<b>Operating condition</b>			
Protection class	II/III		
Degree of Protection	IP54		
Ambient Temperature	-30~+55°C		
Ambient Humidity	5~95%RH		
Non-operating Temperature	-40~+80°C		
<b>Dimensions &amp; weight</b>			
Spindle diameter	 10-20mm		
Weight (Kg)	2.4		
Certificates	CE, UKCA, UL, RoHS		

# F30S series Spring Return Damper Actuator

## 20Nm Model Type



Model	Torque	Running Time	Nominal Voltage	Auxiliary Switches
F30S-20D24	20Nm	Motor Running <130s; Spring Return<30s	AC/DC 24V Or AC 230V	Without
F30S-20D230				
F30S-20M24				
F30S-20D24-S				With 2 SPDT
F30S-20D230-S				
F30S-20M24-S				

## F30S-20 Specification

Items	F30S-20D24	F30S-20D230	F30S-20M24
	F30S-20D24-S	F30S-20D230-S	F30S-20M24-S

### Electrical parameters

Nominal Voltage (V)	AC/DC 24V 50/60Hz	AC 230V 50/60Hz	AC/DC 24V 50/60Hz
Nominal Voltage	AC/DC19.2-28.8V	AC 85-265V	AC/DC19.2-28.8V
Power consumption (on)	7W		
Power consumption (off)	2.5W		
Cable	2/3 point: 1m cable 3*0.75mm <sup>2</sup> ; Modulating: 1m cable 4*0.5mm <sup>2</sup> ; Positional Feedback: 1m cable 6*0.5mm <sup>2</sup>		

### Technical parameters

Torque	20Nm		
Damper Area (m <sup>2</sup> )	4		
Running Time	Motor Running<130s; Spring Return<30s		
Control Signal	2 point		0(2)-10V
Angle of Rotation	0~90° (max 93°)		
Direction of Rotation	L/R switch		
Positional Feedback	None		None or 2 SPDT
Life Cycle	≥70000		
Noise Level	50dB and 62dB		

### Operating condition

Protection class	II /III		
Degree of Protection	IP54		
Ambient Temperature	-30~+55°C		
Ambient Humidity	5~95%RH		
Non-operating Temperature	-40~+80°C		

### Dimensions & weight

Spindle diameter		10-20mm
Weight (Kg)	2.4	
Certificates	CE, UKCA, UL, RoHS	

# F30S series Spring Return Damper Actuator

## F30S-3.5 Unit Dimension (mm)

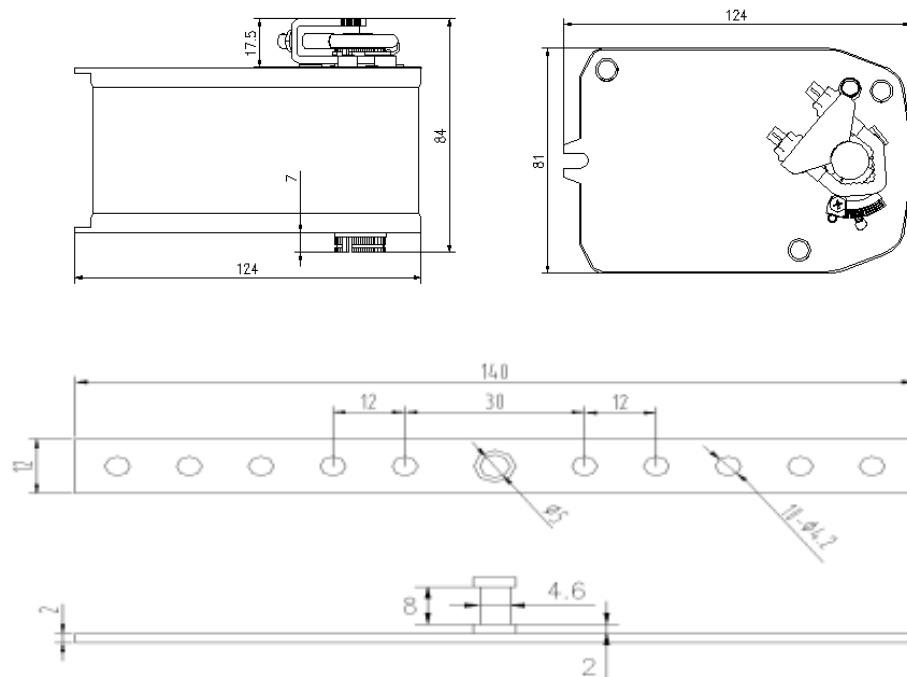
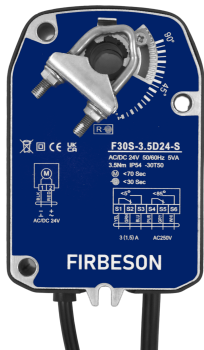

## F30S-5 Unit Dimension (mm)

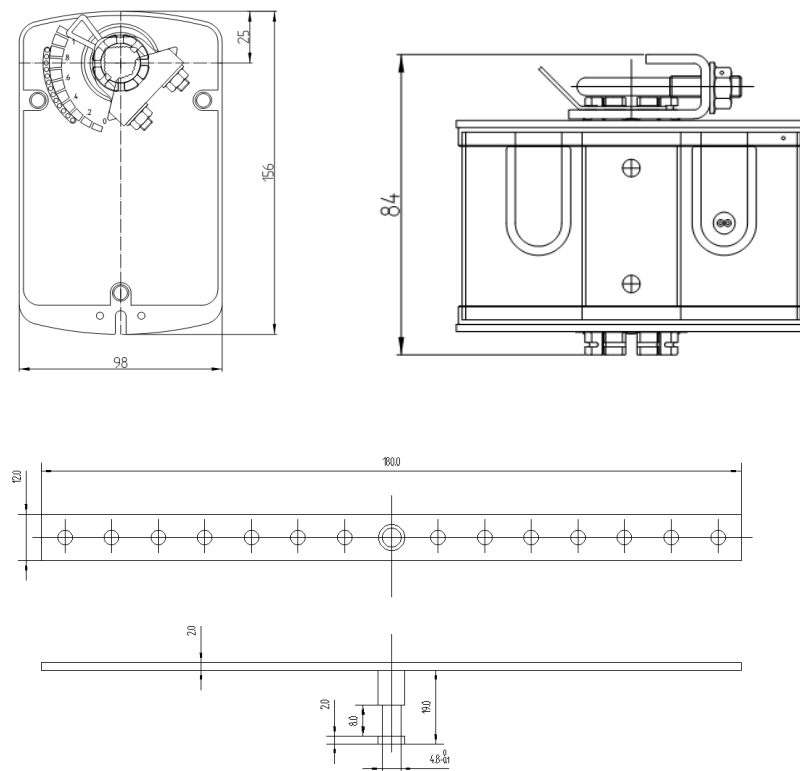
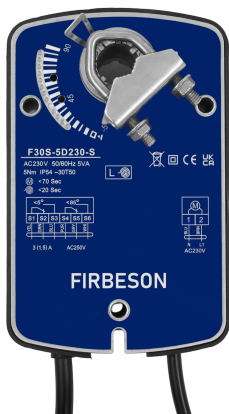



# F30S Electrical installation & other specification

## Electrical Installation

2 point

Modulating

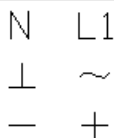
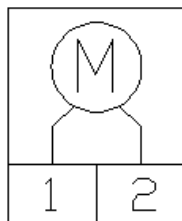

24VAC/DC ± 10%  
230VAC ± 10%

## Auxiliary Switches

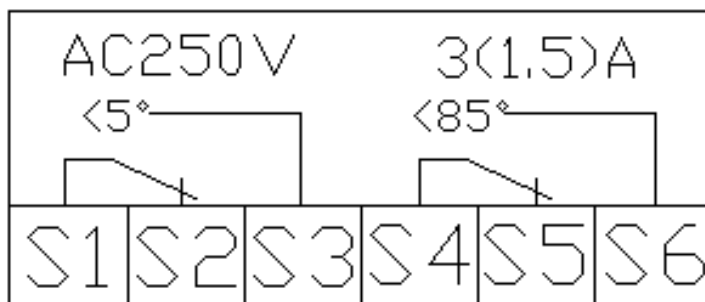

## Specification for F30S5M24-S Auxiliary Switches

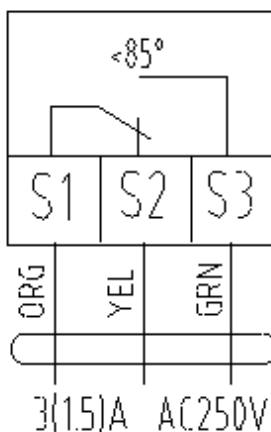

Installation must be carried out by personnel who have received relevant training or work experience. During the installation process, be careful not to operate with electricity and install the actuator according to regulations.