

Electric Control Ball Valves



The electric control ball valve is specially designed for the flow control requirements of media such as water, steam, and 50% ethylene glycol in the HVAC system.

Features:



- Equal percentage flow characteristics,
- There are three control modes: switch control, floating point control and continuous adjustment.
- DN15~50 nominal pressure: 2.0Mpa,
- DN65~150 nominal pressure: 1.6Mpa.

Product Code Description:

Actuator Model+**B X X X X**

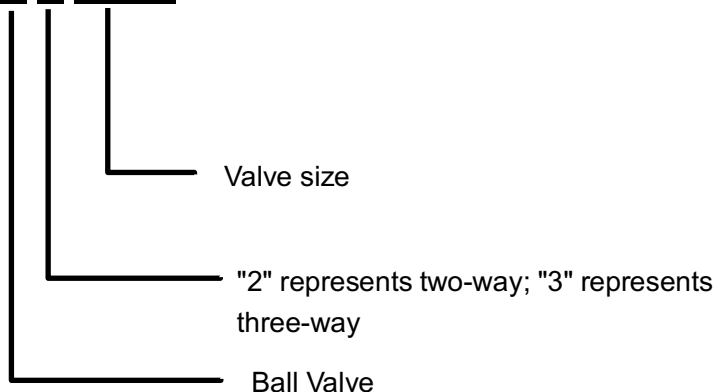

Electric Control Ball Valves

Ball Valve and Actuator Configuration



Ball Valve Diameters	DN15~DN32	DN40、DN50	DN65、DN80	DN100、DN125	DN150
Actuator Torque	5Nm	10Nm	20Nm	30Nm	40Nm

Technical Specifications

Items	DN	(A-B)Way KV (m ³ /h)	Bypass KV (m ³ /h)	Rotatio n Angle	Pressure Differenc e	2-Way (Kg)	3-Way (Kg)
B2 (3) 015A	15	1.3	1.6	0-90°	0.35Mpa	0.2	0.25
B2 (3) 015B		2.5	2.5				
B2 (3) 015C		3.6	4.0				
B2 (3) 015D		4.6	5.0				
B2 (3) 020A	20	2.3	2.5			0.35	0.4
B2 (3) 020B		4.5	4.0				
B2 (3) 020C		6.5	5.0				
B2 (3) 025A	25	9.5	6.3			0.55	0.7
B2 (3) 025B		23.5	8.0				
B2 (3) 032A	32	15	10.0			0.85	1.10
B2 (3) 032B		36	12.5				
B2 (3) 040A	40	24	16.0			1.2	1.4
B2 (3) 040B		36	20.0				
B2 (3) 050A	50	42	25.0			1.95	2.20
B2 (3) 050B		60	31.5				
B2065A	65	43	---	4.5	---		
B2080A	80	77	---	6.8	---		
B2100A	100	108	---	8.1	---		
B2125A	125	204	---	12.0	---		
B2150A	150	260	---	18.8	---		

Flow Direction Description

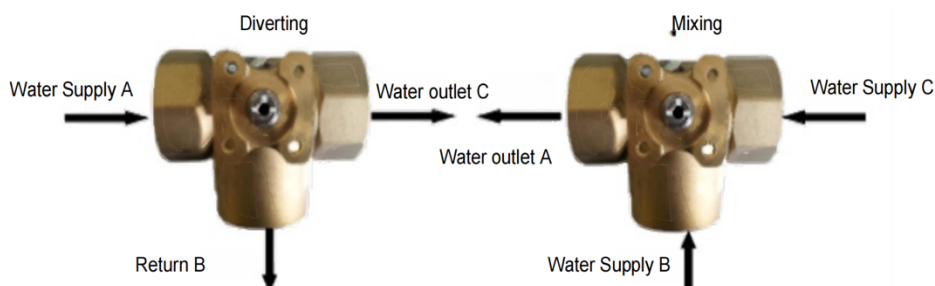

Electric Control Ball Valves

DN15–DN50 Dimensions: Unit (mm)

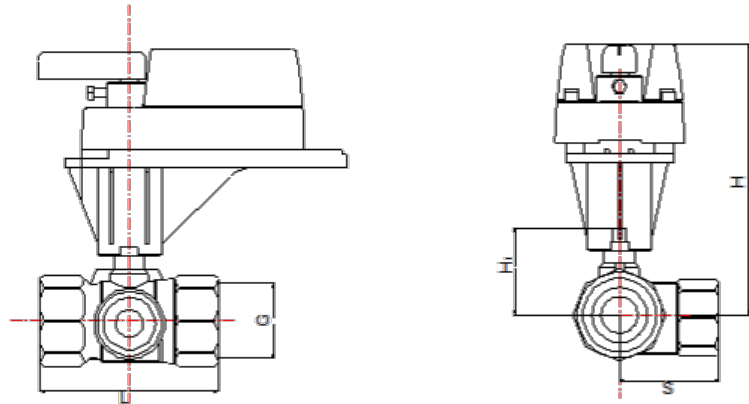

Items	G	H (mm)	H1 (mm)	L (mm)	S (mm)
B2015	G1/2	130	37.5	60	---
B2020	G3/4	130	44	73	---
B2025	G1	135	47	89	---
B2032	G1-1/4	140	52.5	102.5	---
B2040	G1-1/2	145	57	113	---
B2050	G2	150	62	127.5	---
B3015	G1/2	130	39	60	30.5
B3020	G3/4	130	44	66	32
B3025	G1	135	47	89	46.5
B3032	G1-1/4	140	52.5	98.5	49
B3040	G1-1/2	145	57	106	52
B3050	G2	150	62	123	69

Note: DN15~50 uses BSPP British standard parallel pipe thread connection.

DN15-DN80 Ball valve installation diagram

Step 1



Step 2



Step 3

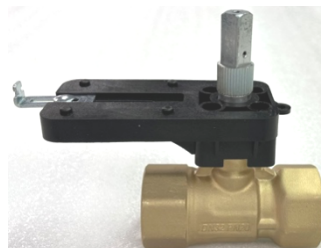

Step 4

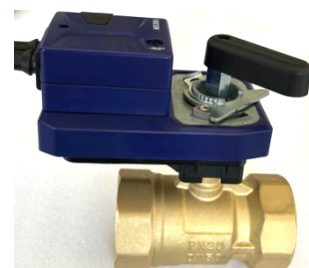

Electric Control Ball Valves

DN65–DN150 Dimensions: Unit (mm)

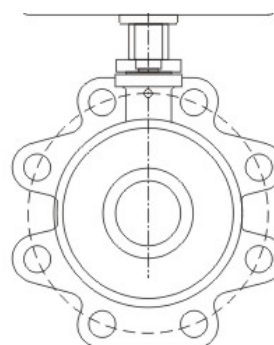
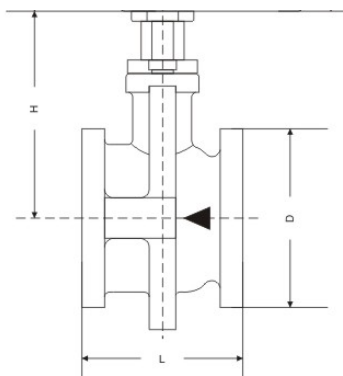

Items	Pitch Circle	L (mm)	D (mm)	H (mm)	n-d
B2065	145	97	105	136	4-18
B2080	160	108	125	140	8-18
B2100	175	120	145	104	8-18
B2125	200	145	175	115	8-18
B2150	230	165	205	138	8-18

Caution: To avoid injuries whilst the valve is closing, do not put fingers inside when the valve is open.

DN100-DN150 Ball valve installation diagram

Step 1



Step 2



Step 3



Step 4



1. The installation must be carried out by personnel who have received relevant training or relevant work experience. During the installation process, be careful not to operate with power on, and install the actuator according to the regulations.
2. The device contains electrical and electronic accessories, so it is prohibited to dispose of it as ordinary garbage after the product is scrapped. The disposal method should comply with the regulations and requirements of the local government.